

New Building Level L3

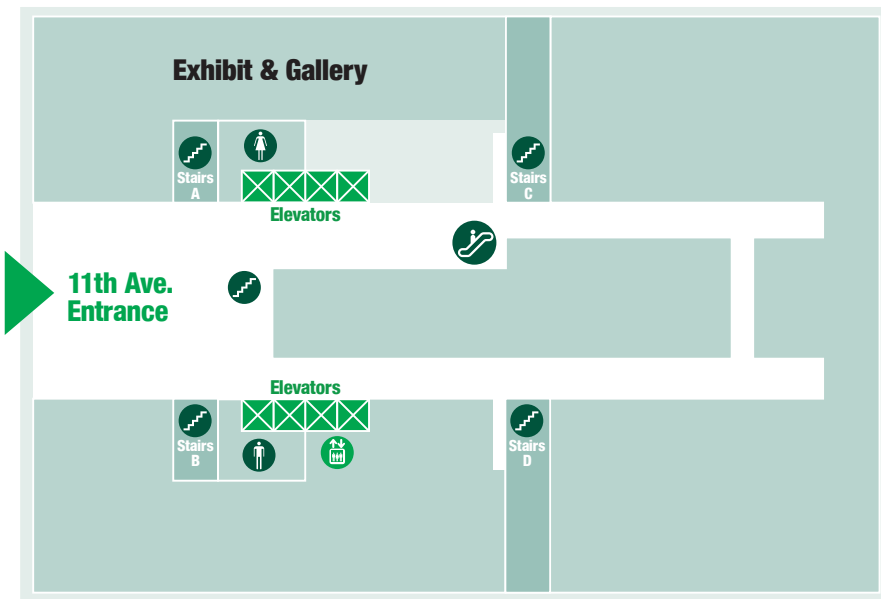

L3

Exhibit & Gallery

L2

Café
Classrooms
Cyber Lounge
Math & Science Resource Center
Writing Center

see other side for L

1

DOIT (Department of Information Technology)
Facilities Management
Instructional Technology Support Services (ITSS) & Computer Labs
John Jay Sentinel
Judicial Board
Public Safety
Reflection Room
Student Life
Student Clubs & Organizations
Student Government



Connection to Haaren Hall will be open in Spring 2012. Take stairs down to L (The Lobby Level) to Haaren Hall.

The Quick Guide to Getting Around the New Building



1st Edition October, 2011



New Building Level L2

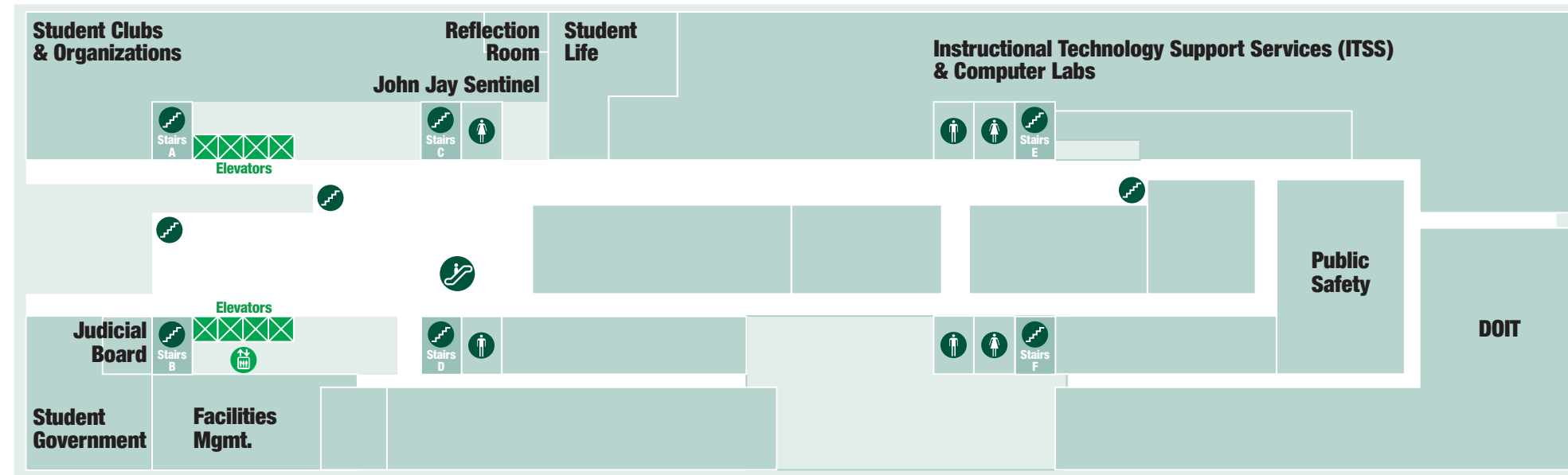

New Building Level 1

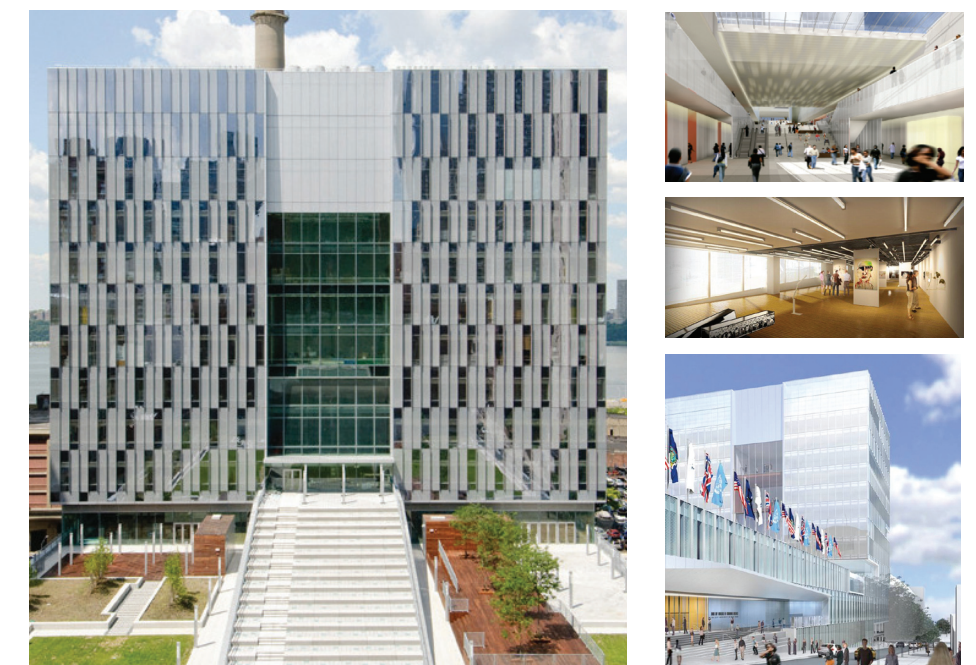
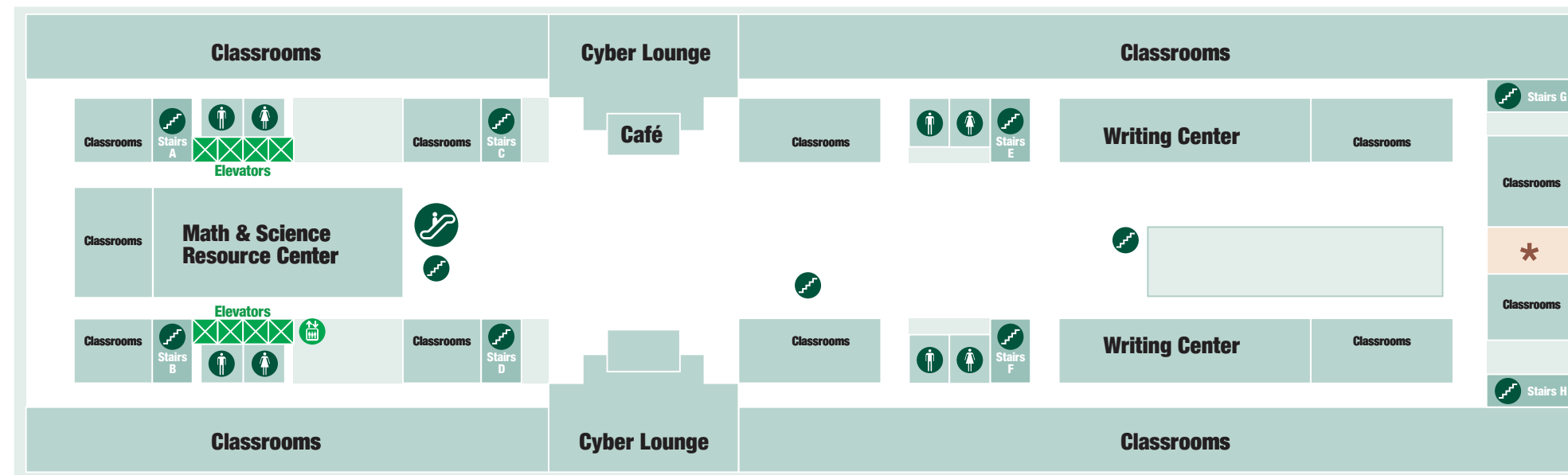

This quick guide provides you with the floors available for use in the New Building as of 10/28. They are located in the Concourse section of the building.

Departments and offices will continue to be relocated in stages throughout the remainder of 2011 and through 2012. Most Academic Departments will relocate from North Hall in January. Please check the Campus Guide for additional details and visit the New Building web page at www.jjay.cuny.edu

New Building

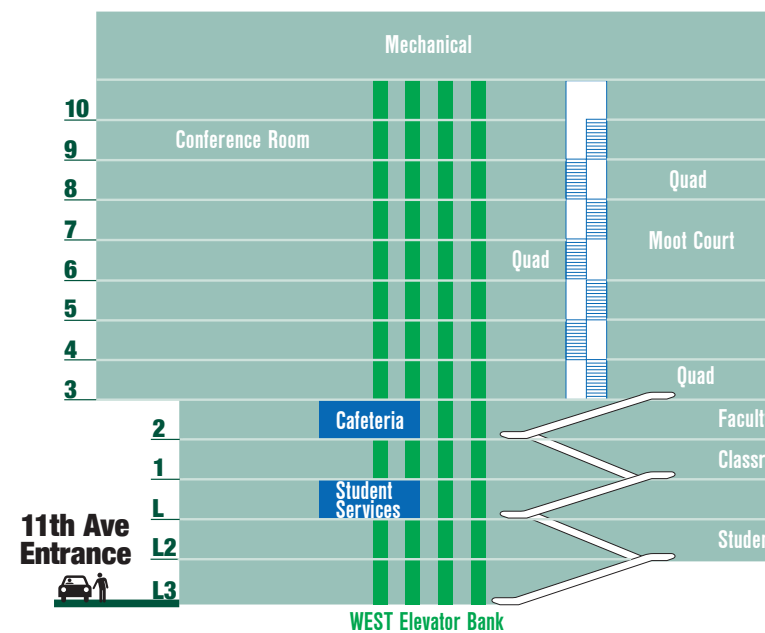

Haaren Hall

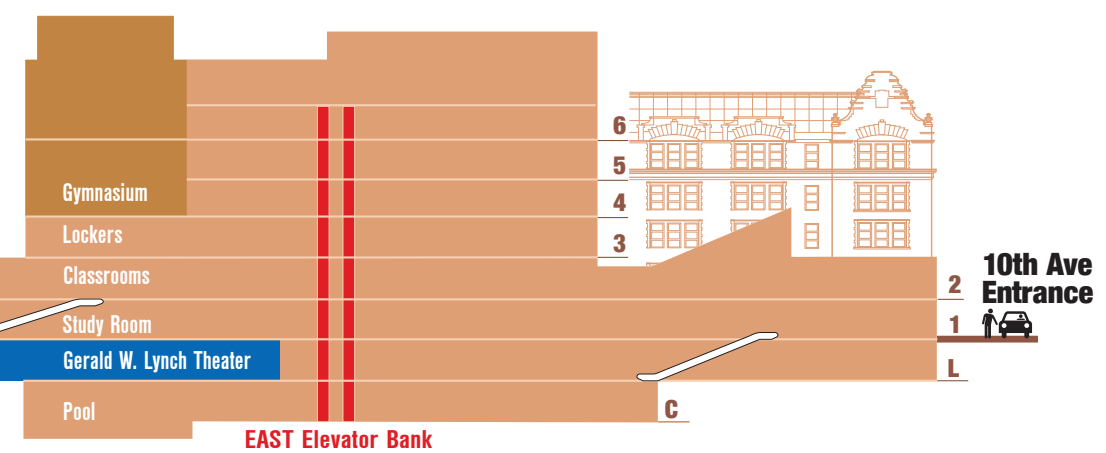

11th Ave Entrance

59th St. Entrance

10th Ave Entrance

DEPARTMENT NAME	FLOOR	BUILDING	DEPARTMENT NAME	FLOOR	BUILDING	DEPARTMENT NAME	FLOOR	BUILDING	DEPARTMENT NAME	FLOOR	BUILDING	DEPARTMENT NAME	FLOOR	BUILDING	DEPARTMENT NAME	FLOOR	BUILDING
Academic Advisement Center/Justice Academy	L	New	Central Receiving & Stockroom	L	Haaren	DOIT (Department of Information Technology)	L2	New	ITSS & Computer Labs	L2	New	PDP Lab (Professional Development Program)	L	New	Student Clubs & Organizations	L2	New
Academic Affairs	6	Haaren	Classrooms	2, 3, 5, 6	Haaren	Development Through Life Cycle	6	Haaren	Jay Express Offices	L	New	Ph.D Program	6	Haaren	Student Government	L2	New
Accessibility Services	L	New	Classrooms	1	New	Enrollment Management	L	New	Jay Express Services Counter	L	New	Philosophy	3	Haaren	Student Life	L2	New
Advancement of Research	6	Haaren	Combative Gymnasium	3	Haaren	Exhibit & Gallery	L3	New	John Jay Sentinel	L2	New	Pool	Cellar	Haaren	Tennis Court	6	Haaren
Anthropology	4	Haaren	Communication & Theater Arts	3	Haaren	Facilities Management	L2	New	Judicial Board	L2	New	President's Office	6	Haaren	Testing Offices & Labs	L	New
Art & Music	3	Haaren	Communication & Theater Arts Labs	4	Haaren	Finance & Administration	6	Haaren	Law & Police Science	4	Haaren	Print Shop	Cellar	Haaren	Theater Lobby	L	New
Audio Visual Services	3	Haaren	Conference Center	L	New	Fitness Center	6	Haaren	Law & Police Science	4	Haaren	Public Safety	L2	New	TV Studio	3	Haaren
Bursar's Office	5	Haaren	Counseling Services	L	New	Gerald W. Lynch Theater	L	Haaren	Computer Labs	6	Haaren	Reflection Room	L2	New	Undergraduate Admissions	L	New
Café	1	New	Criminal Justice	6	Haaren	Graduate Admissions	L	New	Legal Counsel	6	Haaren	Running Track	Roof	Haaren	Undergraduate Studies	5	Haaren
Center for Career & Professional Development, Community Outreach and Service Learning	L	New	Doctoral Program	4	Haaren	Graduate Studies	4	Haaren	Library	L	Haaren	Sociology	5	Haaren	Urban Male Initiative	L	New
Center for the Advancement of Teaching & Learning	3	Haaren	Cyber Lounge	1	New	Gymnasium	4	Haaren	Mailroom	5	Haaren	Space Planning & Capital Projects	5	Haaren	Veteran's Services	L	New
			Dance Studio	C	Haaren	Health & Physical Education	4	Haaren	Marketing & Development	6	Haaren	Sponsored Programs	6	Haaren	Weight Room	C	Haaren
						Health Office	L	New	Math & Science Resource Center	1	New	Student Affairs	L	New	Women's Center	L	New
						Interdisciplinary Studies	4	Haaren							Writing Center	1	New

New Building L - The Lobby Level (connecting New Building and Haaren Hall)

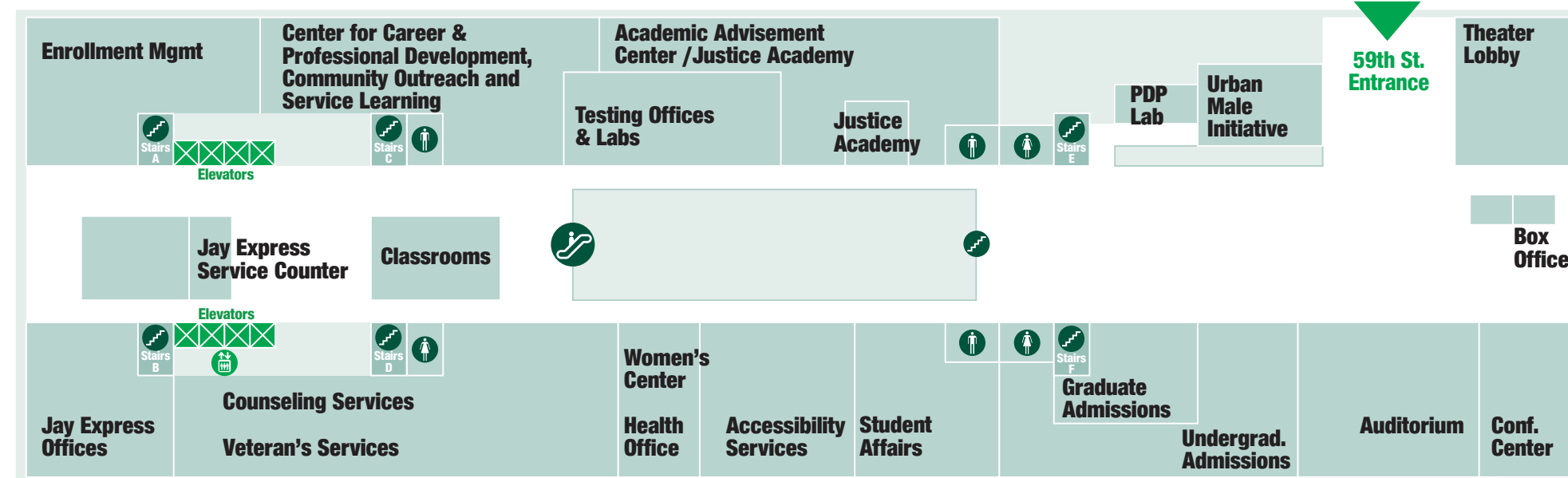

Haaren Hall L - The Lobby Level

